

Lawn Gardens, London, London, W7

Approximate Area = 577 sq ft / 53.6 sq m
Outbuilding = 17 sq ft / 1.6 sq m
Total = 594 sq ft / 55.2 sq m
For identification only - Not to scale

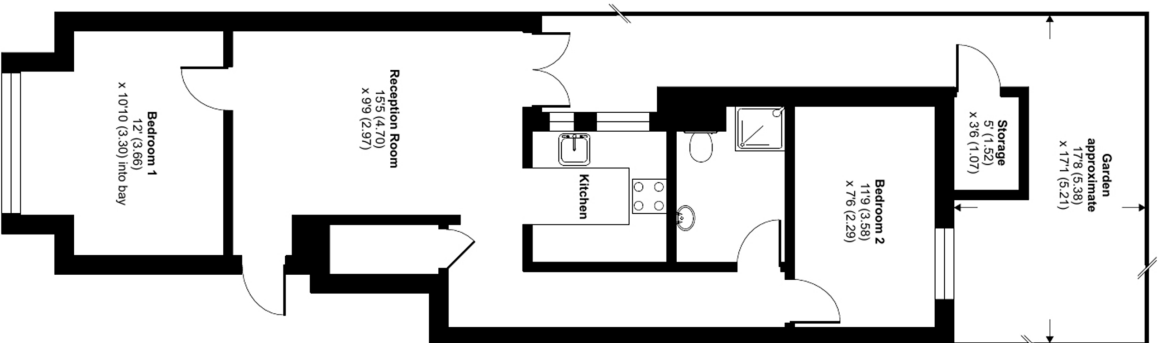

GROUND FLOOR



Floor plan produced in accordance with RICS Property Measurement Standards incorporating International Property Measurement Standards (IPMS2 Residential). © nchcom 2023. Produced for So Moves. REF: 960316

So Moves

RESIDENTIAL SALES



19 Lawn Gardens, Hanwell, W7 3JN



£430,000

19 Lawn Gardens, Hanwell, W7 3JN

So Moves London is delighted to bring to the market No. 19 Lawn Gardens.

This cosy 2-bedroom property comprises the entire ground floor of this charming Edwardian period home on a much sought after tree-lined street in Hanwell village.

The property is within easy walking distance of shops and restaurants as well as Hanwell train station, where you can pick up the newly opened Elizabeth line that runs every 10 minutes from Heathrow airport or Reading through central London and on to Abbey Wood in south east London or Shenfield, north east London.

Homes don't tend to stay on the market for long in this well-located area, where you can walk to the many restaurants, shops and bars of Hanwell Broadway, and yet be in Hanwell zoo within the Bunny Park in just 5 minutes' at just 0.2miles either way.

The property boasts a sunny enclosed private back garden to enjoy outdoor BBQs during the summer and with plenty of room for raised flower beds you could try your hand at some vegetable gardening too.

19 Lawn Gardens, Hanwell, W7 3JN

House Type: Ground Floor Conversion Flat

Selling Type: Private Treaty

Tenure: Share of Freehold

Price: £430,000



Contact: So Moves London

Tel: 020 4551 9027

E: Sales@SoMoves.co.uk

W: SoMoves.co.uk